

LEVERAGING E-CADASTRE FOR NATIONAL ECONOMIC TRANSFORMATION

*Sr Dr Teng Chee Hua
Cadastral Division, JUPEM
Malaysia*

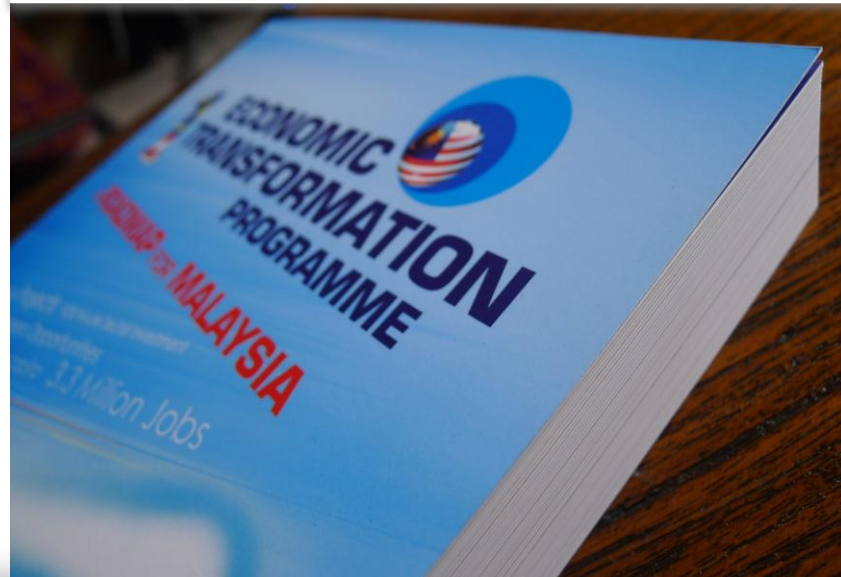

INTRODUCTION

Malaysia has progressed from an economy dependant on agriculture and primary commodities to a manufacturing based, export driven economy.

To move the country forward the Government has crafted a framework comprising four (4) pillars to drive the change





VISION 2020

Aspiring to Achieve Developed and High-income Nation Status

1 NATIONAL TRANSFORMATION PROGRAMME



NATIONAL KEY RESULTS AREAS (NKRAs)



NATIONAL KEY ECONOMIC AREAS (NKEAs)



STRATEGIC REFORM INITIATIVES (SRIs)





Oil, Gas and Energy



Palm Oil & Rubber



Financial Services



Tourism



Business Services



Electronics & Electrical



Wholesale & Retail



Education

**The 12
NKEA's**

NKEA's



Healthcare



**Communications
Content and
Infrastructure**



Agriculture



**Greater Kuala
Lumpur/ Klang Valley**

Digital Malaysia

```
graph TD; DM((Digital Malaysia)) --> FDS((Fast Delivery System)); DM --> NSDI((NSDI Marine)); DM --> CN((Customers Need)); DM --> SD((Spatial data)); DM --> MaCGDI((MaCGDI)); DM --> GT((Global Trend)); DM --> UDB((Utility DB)); DM --> MT((Mobile Technology)); DM --> DD((Data Dissemination)); DM --> WB((Web Based));
```

Fast Delivery System

NSDI Marine

Web Based

Customers Need

Data Dissemination

Spatial data

Mobile Technology

MaCGDI

Utility DB

Global Trend

Geospatial Initiatives

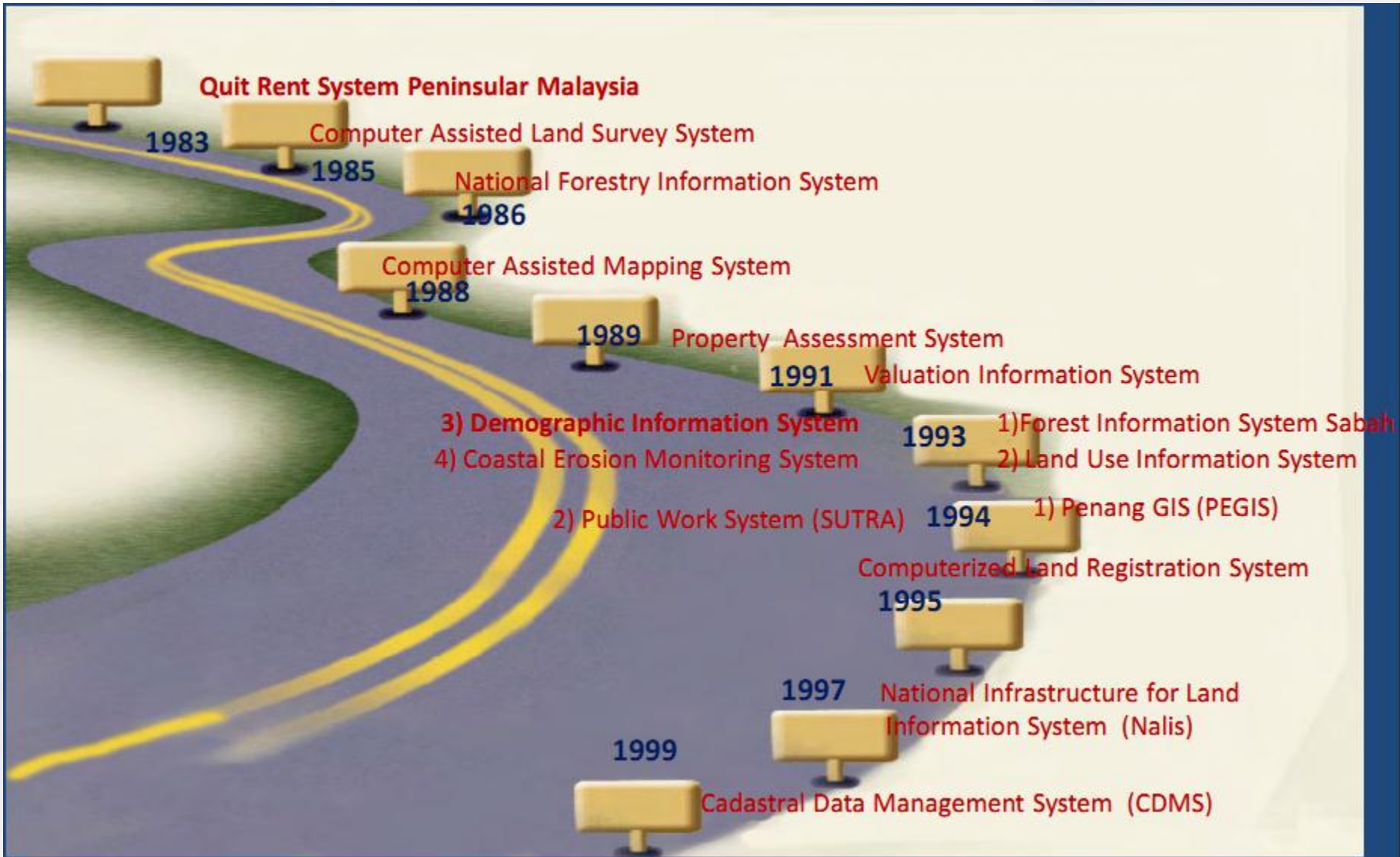

TOWARDS A SPATIALLY ENABLED GOVERNMENT

SPATIALLY ENABLED TECHNOLOGY

GPS/GNSS

Total Station

**Ground/Airborne
Laser Scanning
Technology**

**Ocean Mapping
Systems**

Satellite Imagery

**Airborne Sensors
(Radar/Gravity/
Magnetic)**

**Space borne Sensors
(Radar /Altimetry/Etc)**

SPATIALLY ENABLED PLATFORM

**National Geospatial
Data Centre (NGDC)**

**State Geospatial Data
Centre(SGDC)**

**Local Geospatial Data
Centre (LGDC)**

**National Digital
Cadastral Database
(NDCDB)**

**Multi Purpose
Cadastre**

PADU

**Marine Geospatial
Data Centre (MGDC)**

SPATIALLY ENABLED SYSTEM

Utility Information System

**Land Administration
System (eTANAH)**

G4NRE, MyLIIS, G4E

**Planning Information
System**

**GIS System For Local
Authorities**

**Environmental
Management System**

Defense GIS System

**Coastal And Marine
Geoinformation System**

SPATIALLY ENABLED GOVERNMENT

Economic Development

Land Administration

Public Works

**Urban & Regional
Planning**

**Real Estate And
Facilities Management**

National Security

Public Safety

Tourism

**Integrated Coastal Zone
Management (ICZM)**

**Sustainable
Development**

BASE MAP (NDCDB/Utility/Mapping)

NATIONAL GEOSPATIAL REFERENCE FRAME (MyRTKnet/MyGeoid)

**Federal
Department of
Survey and Mapping**

**Licensed
Surveyors**

**Land
Office**

**Cadastral
Survey**

State

**Torrens
System**

CLRS

eKADASTER

**Land &
Mines
Office**

**Data
Integration**

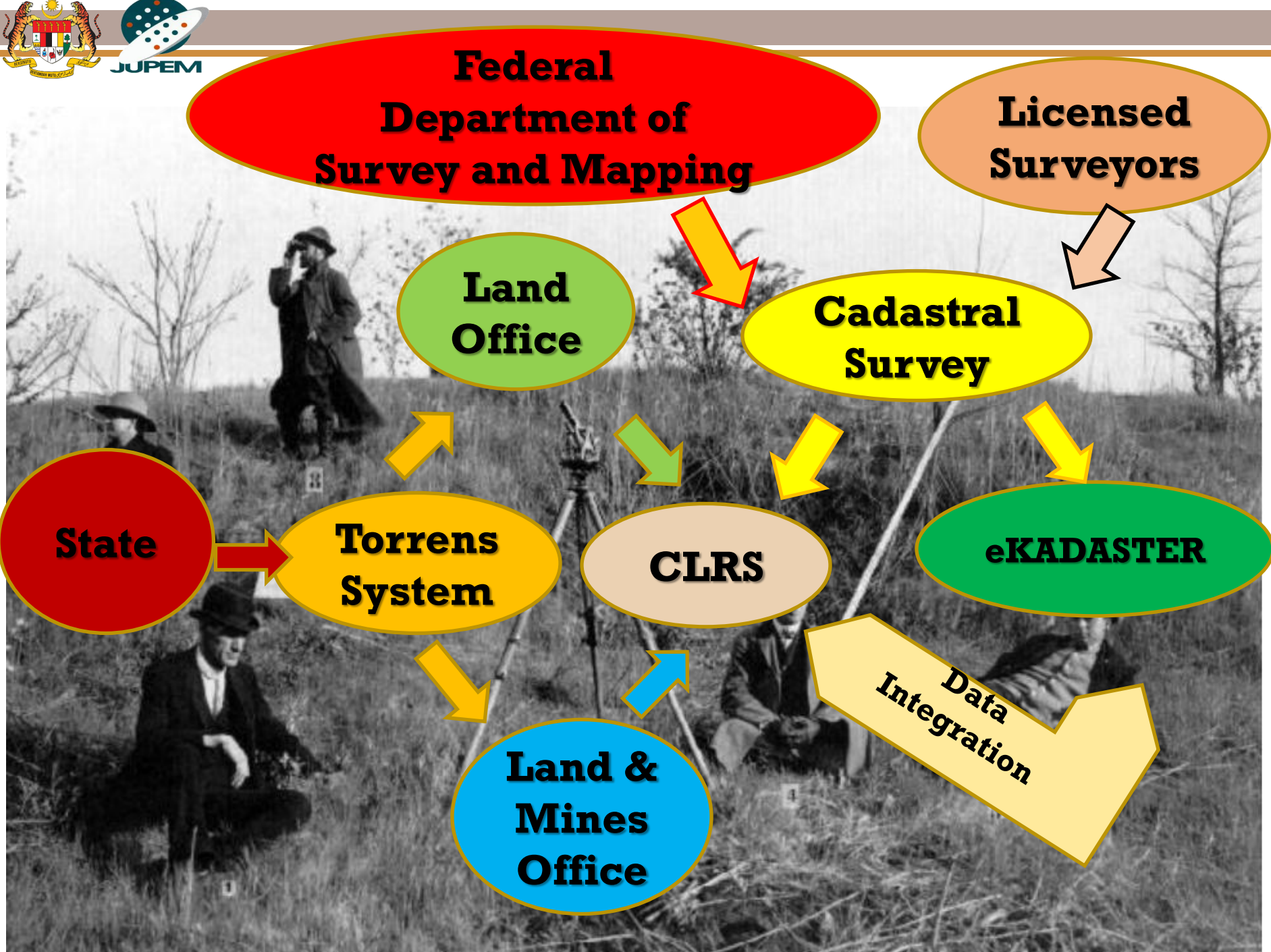

Benefits of Cadastral & Land Survey to the nation



Guarantees an indefeasible title to those included in the register

Conclusive proof that the person mentioned in Title is the owner of the land

Reduces disputes and confirm quality by survey and demarcation

Lowering the risk of investment

Facilitate development of new township

Increase business and investment



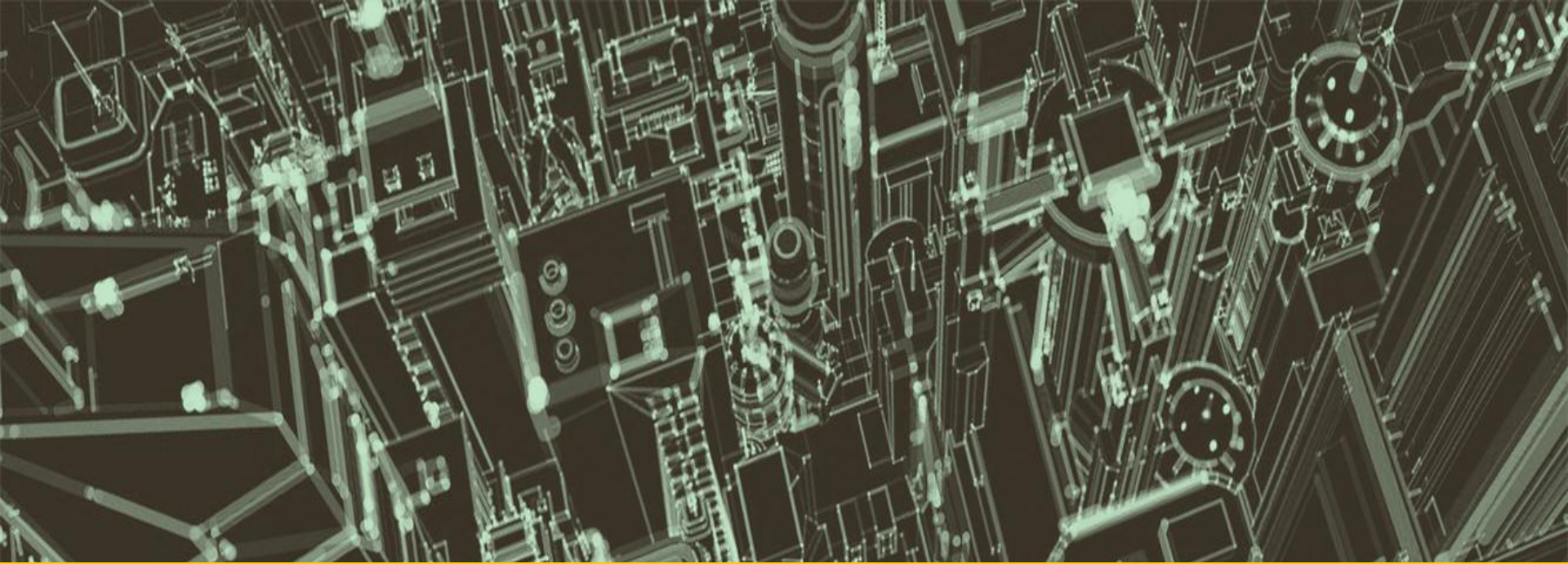

The Cadastral Survey Reform





The System Reformation

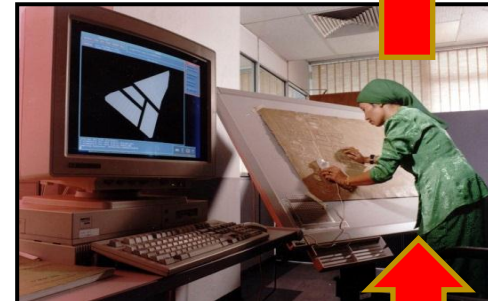
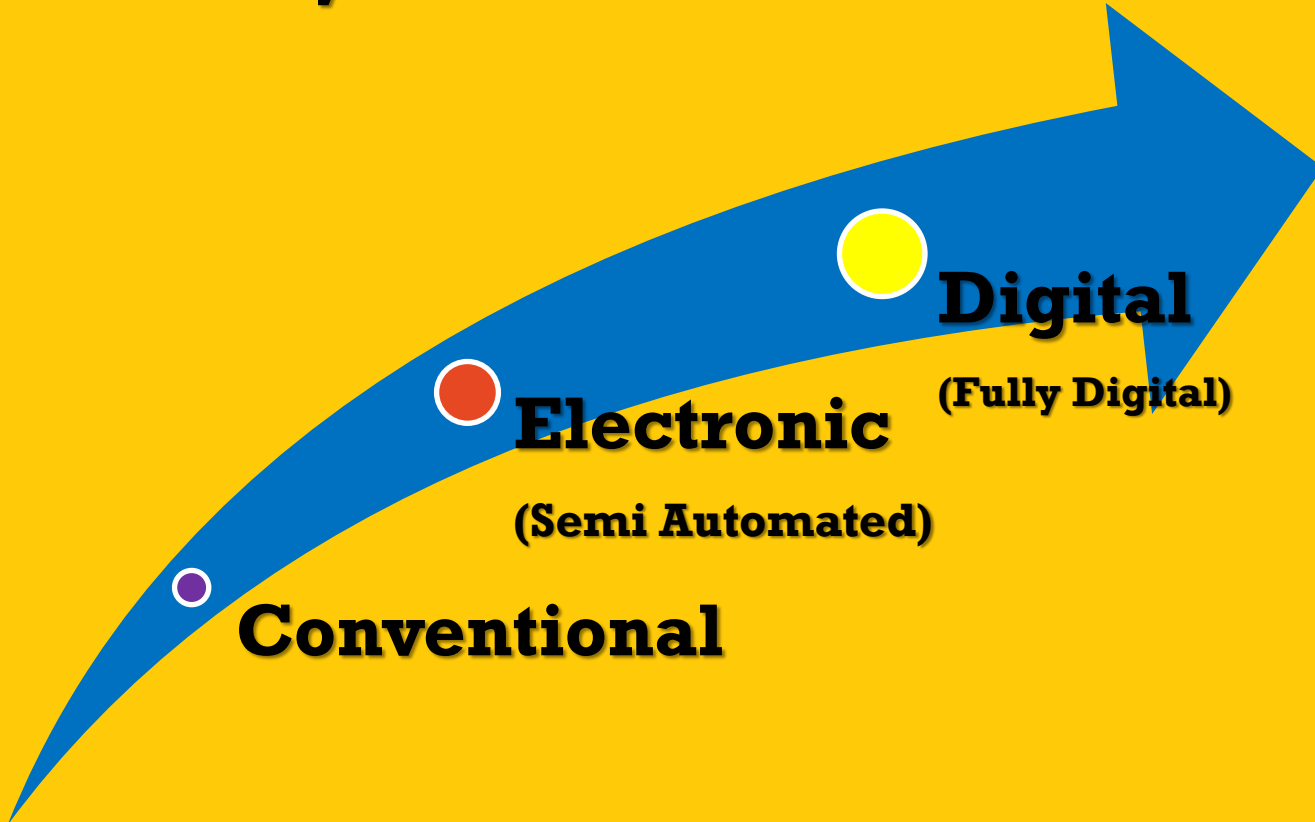

Objective Reformation: Expediting Cadastral Services

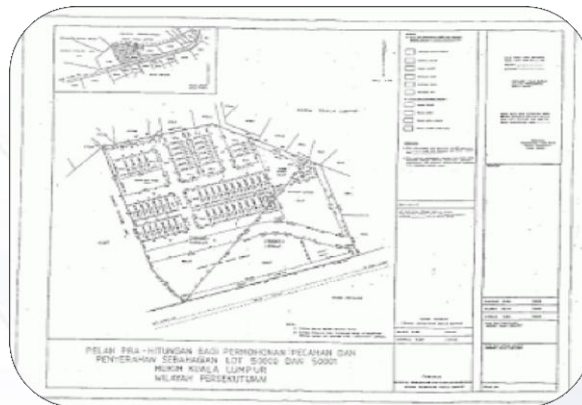

Qualified Titles

- Introduced in 1965
- To cater Cadastral Survey rising demands
- Issuance of title in advance of final survey
- Supports vibrant land market
- Instigating more land ownership units (QT) than surveyed land parcels (FT)

Pre Comp Plans

- Under NLC, Pre Comp Plans is prepared to show the intended new boundaries and areas of those lots which are based on computation from existing survey
- Promote Land development planning, land dealings and prevent encroachment

Digital environments

- Replacing conventional processing method phase by phase as early as 1985
- The digital environment concept gradually extended from Field to Finish

Modernisation Programmes

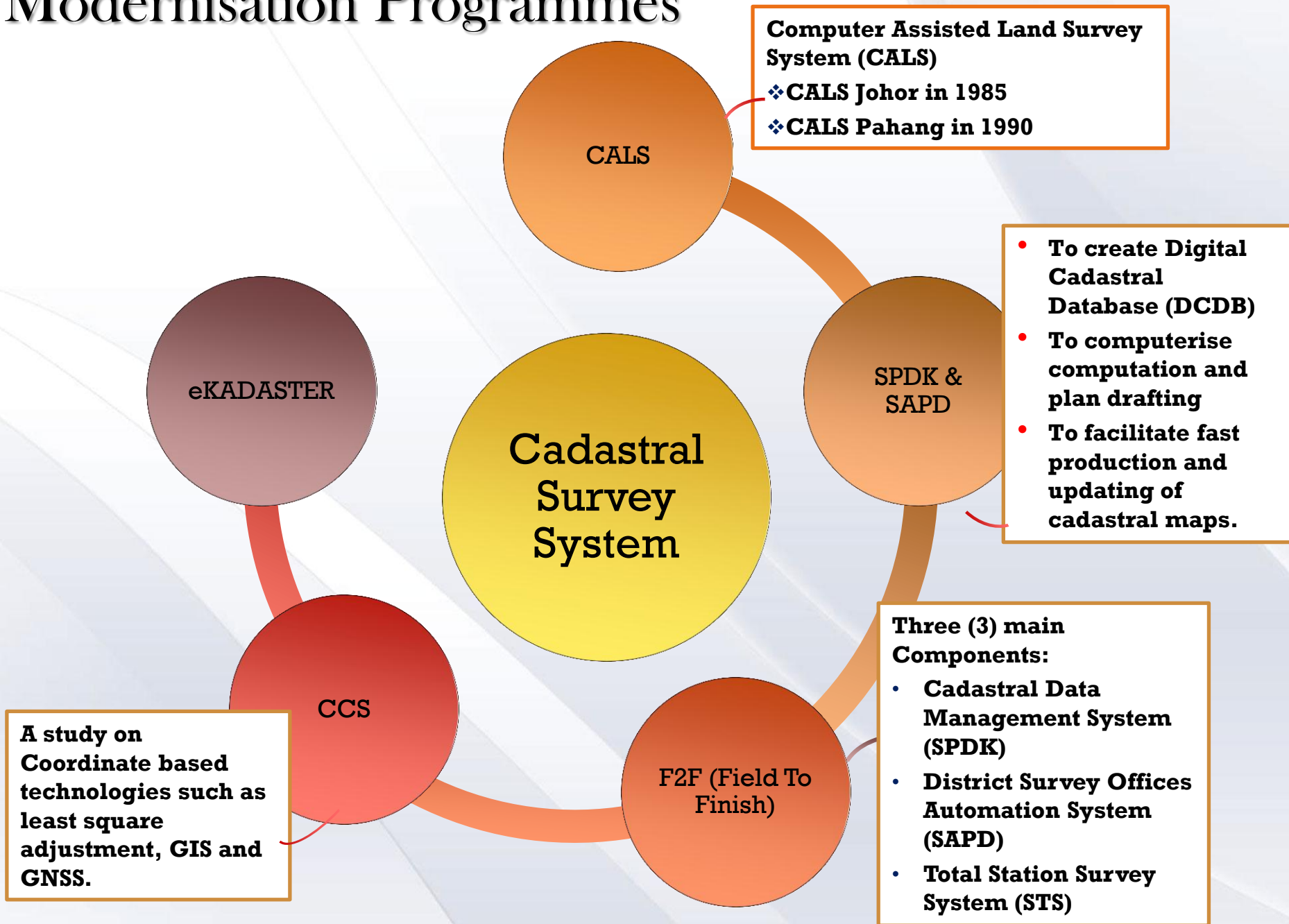

INTEGRATION WITH eTANAH

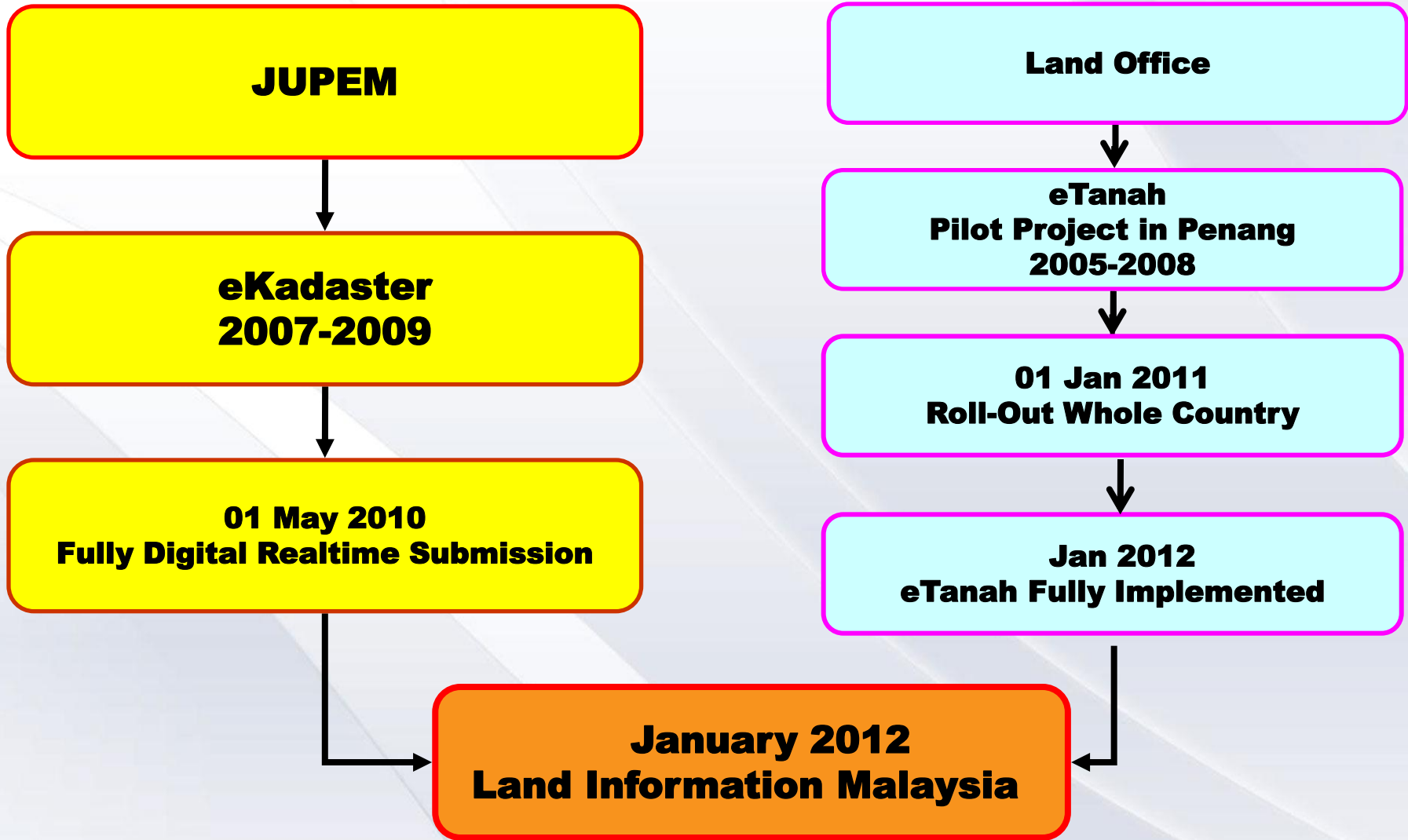



Requisition for Survey

Survey Registration

Field Tracing Preparation

Field Survey

Survey Data Verification

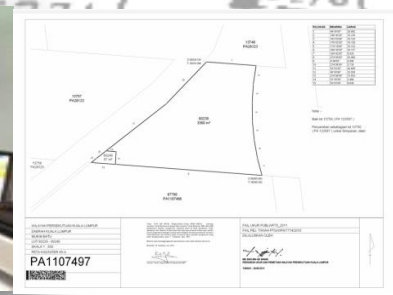
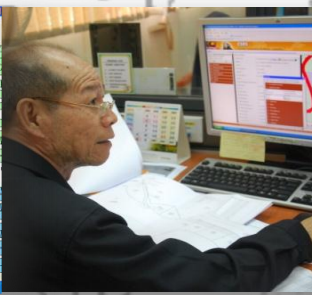
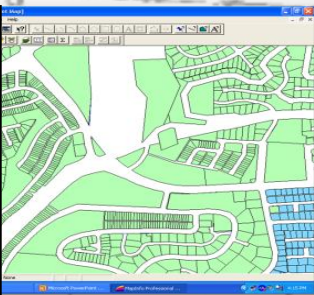

Updating Cadastral Survey Database

Certified Plan Approval

Certified Plan

Cadastral Survey Workflow (Digital)



Impact of eKadaster in boosting Malaysian economic growth by:

- Expedite the Cadastral Survey delivery system
- Increasing FT registration;
- Crown Jewel : National Digital Cadastral Database;
 - Planning tool for land or property development
 - Accurate base maps for asset investment

- Ease of registering property
- Ease of doing business in Malaysia
- Competitiveness in economy performance
- Boost property demand and value

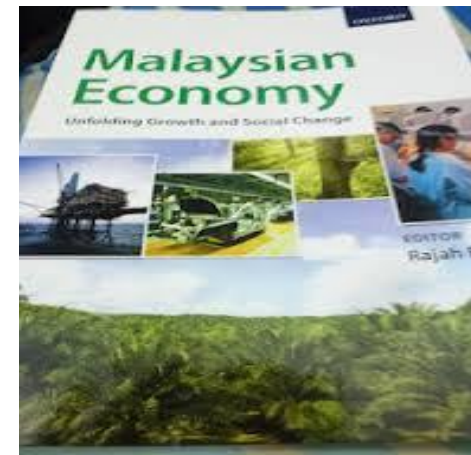

How ?

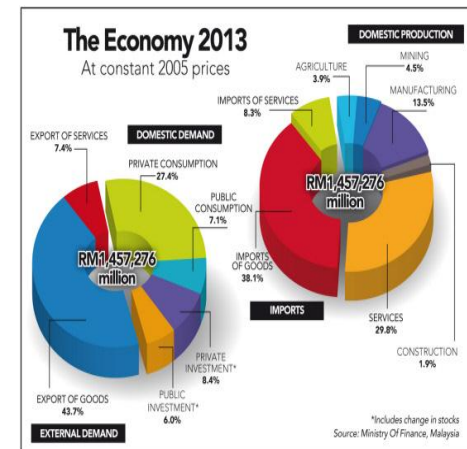

eKadaster

Expedite the Cadastral Survey delivery system

Innovation in Cadastral Survey dealings

Survey Accurate Coordinate

Base maps for GIS system

National Digital Cadastral Database (NDCDB)

Facilitates High Impact Projects

Increased Issuance of Final Titles

Seamless and homogenous Cadastral Survey information

Survey Accurate Spatial Analysis

Mass Rapid Train (MRT)

Double Track Railway

2nd bridge Penang

Iskandar development Region

Improved and support the ease of doing land business and dealings i.e property registry

Accurate base maps

Proper enforcement

Better management

Assist train alignment

Facilitate the design, actual work and as built work

Accurate spatial planning

New land developments and township planning





Numbers of Surveyed Lots with eKadaster environment

STATES	YEAR				
	2010	2011	2012	2013	2014
	(Lot)	(Lot)	(Lot)	(Lot)	(Lot)
Johor	5,462	6,406	9,775	8,560	10,000
Kedah	5,778	7,412	5,976	5,939	6,250
Kelantan	1,539	2,838	5,976	6,490	6,580
Melaka	7,557	9,796	1,086	2,107	1,600
N. Sembilan	4,813	4,814	2,847	3,441	3,104
Pahang	4,175	4,847	5,158	5,757	4,600
Perak	765	1,539	5,942	7,248	7,200
Perlis	451	749	2,298	2,219	2,200
P. Pinang	5,861	5,723	1,807	692	632
Selangor	4,322	7,593	5,673	3,919	4,220
Terengganu	320	155	8,049	8,990	9,200
WP KL/Putrajaya	1,012	2,130	352	253	243
WP Labuan	2,512	728	68	149	140
TOTAL	44,567	54,730	55,007	55,764	55,969

DCDB / NDCDB users (Government Agencies)

No	Government Agencies Users
1	Department of Irrigation and Drainage Malaysia
2	Ministry of Health
3	Election Commission of Malaysia
4	State Land and District Office
5	National Solid Waste Department
6	Valuation and Property Services Department
7	University Technology MARA
8	University Putra Malaysia
9	Department of Town and Country Planning Peninsular Malaysia
10	Department of Agriculture
11	Kuala Lumpur City Hall
12	Malaysian Remote Sensing Agency
13	Ministry of Federal Territories
14	Local Authorities
15	Department of Environment
16	Prime Minister's Office
17	Ministry of Rural and Regional Development
18	Ministry of Home Affairs
19	Malaysia Centre of Geospatial Data Infrastructure
20	Department of Director General of Land and Mines
21	Department of Mineral and Geoscience
22	Ministry of the Federal Territories and Urban Well-being
23	Public Work Department
24	Forestry Department Peninsular Malaysia
25	University Technology Malaysia
26	And others

Year	Waived (RM)
2006	482,032.00
2007	156,696.80
2008	3,112,969.50
2009	3,060,088.00
2010	1,912,051.00
2011	1,602,880.00
2012	3,165,502.20
2013	674,859.10
Total	14,167,079.60

Source: JUPEM

Waived charges are given to Government Agencies for public-based development

Significant of NDCDB

Significant of NDCDB

GIS Basemap

Empower
user's existing
GIS system

Decision
Making Tool

Analysis Tool

Spatially
Enabler

Samples of application optimising NDCDB

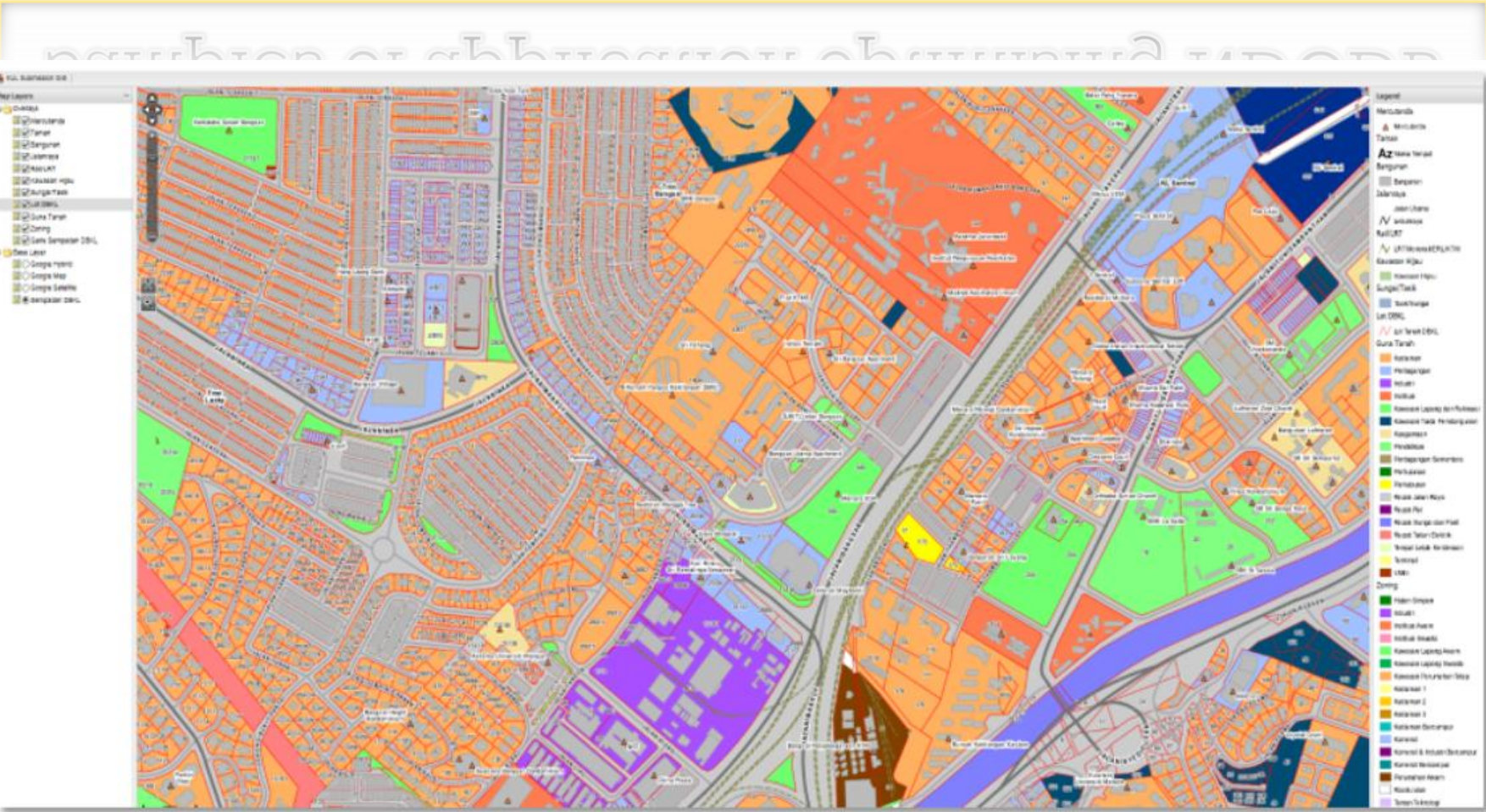

Source: DBKL GIS

Safe City Monitoring System

Samples of application optimising NDCDB

Safe City Monitoring System: A Malaysia First in Crime Prevention

PUTRAJAYA, 1 APRIL 2011 - Despite seeing street crime and the overall index crime dropped by 35percent and 15percent respectively in 2010, efforts are still on-going to ensure that crime prevention initiatives under the Government Transformation Programme (GTP)'s National Key Results Area (NKRA) are on track and sustainable.

To do this, the government through the Federal Department of Town and Country Planning of the Ministry of Housing and Local Government has received an allocation of RM36 million in 2010 from the Ministry of Home Affairs to reactivate and expand the Safe City Programme or SCP (identified as one of the enablers in street crime prevention which was introduced in 2004) in 12 local authorities to reduce street crime.

The twelve local councils have been selected based on the crime rate by area (hotspots) provided by the police (Polis DiRajaMalaysia). The councils are: Dewan Bandaraya Kuala Lumpur (DBKL), Majlis Bandaraya Shah Alam (MBSA), Majlis Bandaraya Petaling Jaya (MBPJ), Majlis Perbandaran Subang Jaya (MPSJ), Majlis Perbandaran Ampang Jaya (MPAJ), Majlis Perbandaran Selangang (MPS), Majlis Perbandaran Klang (MPK), Majlis Bandaraya Johor Bahru (MBJB), Majlis Perbandaran Johor Bahru Tengah (MPJBT), Majlis Perbandaran Pasir Gudang (MPPG), Majlis Perbandaran Pulau Pinang (MPPP) and Majlis Perbandaran Seberang Perai (MPSP).

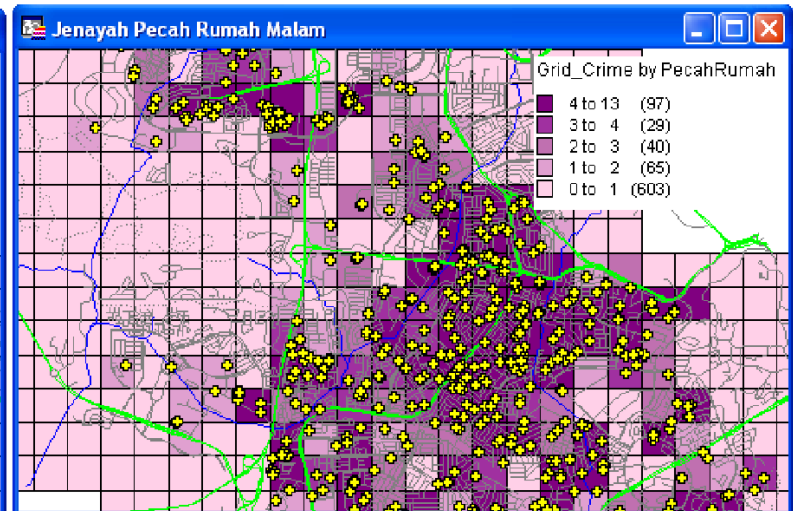
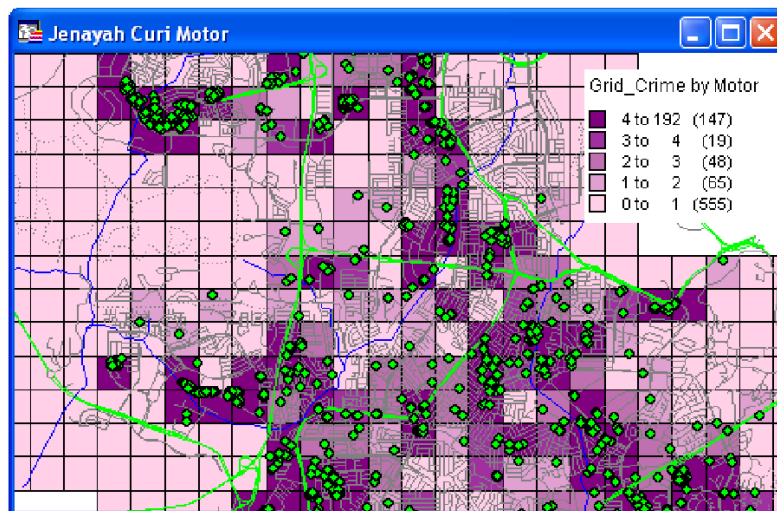

Geospatial Data: Reducing Crime

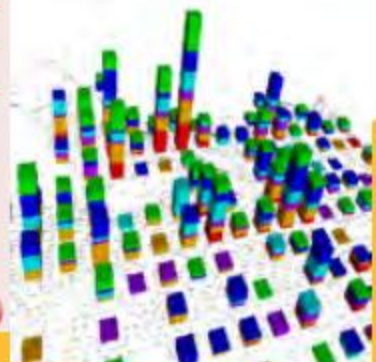
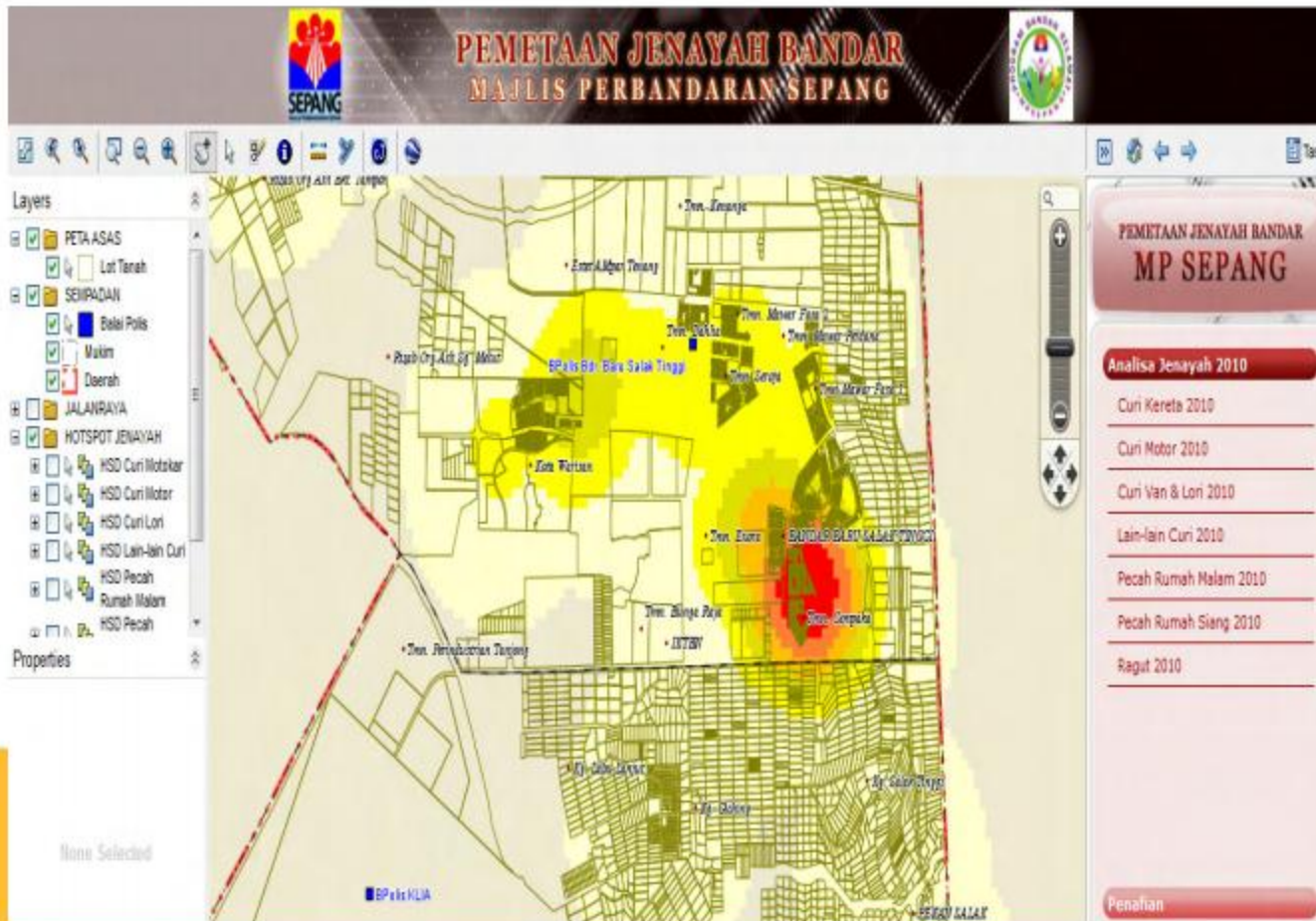

Samples of application optimising NDCDB

MeLGIS | Melaka Geographic Information System

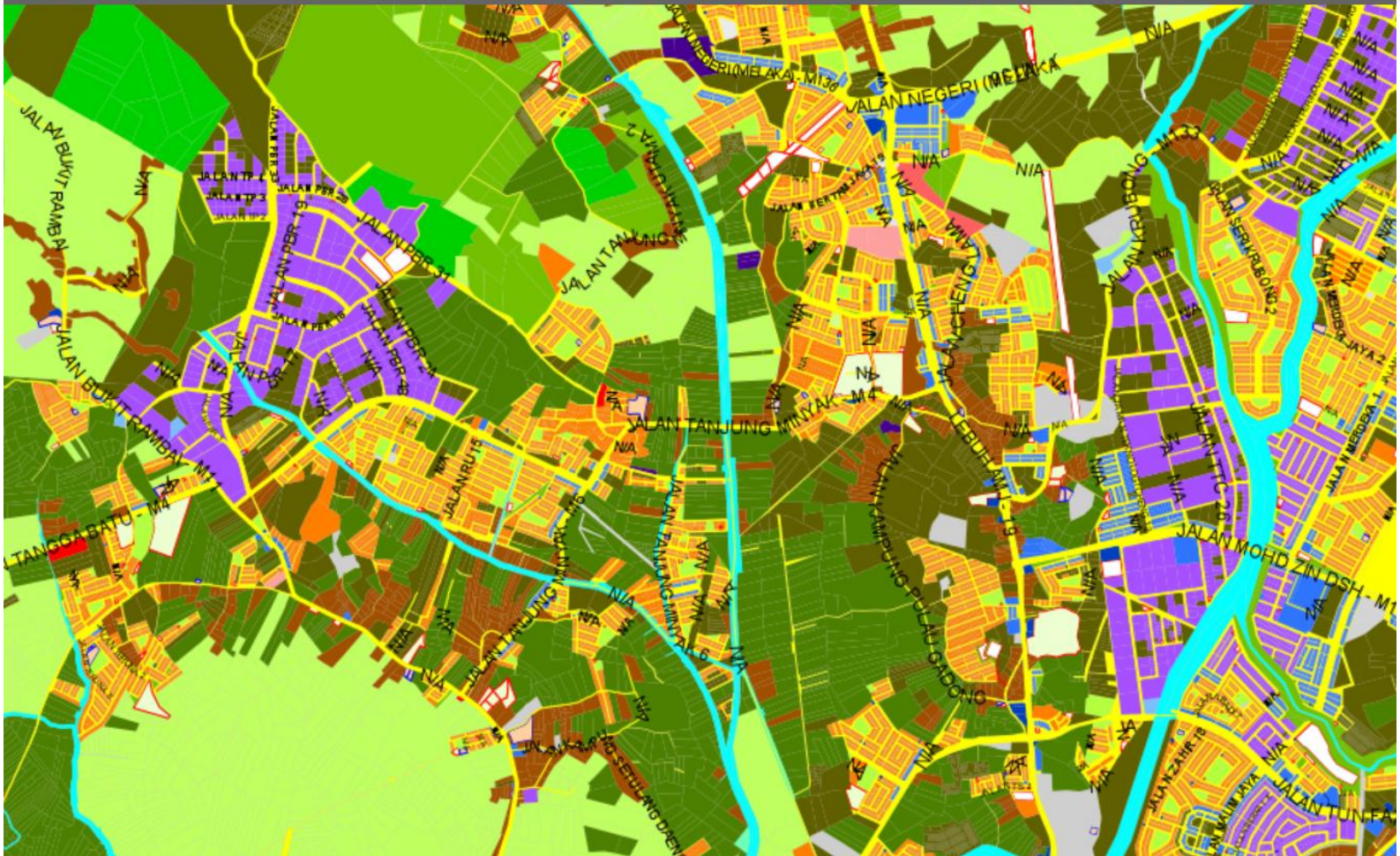



Increased property demand

Existing Space and Occupancy Rate for Commercial Buildings as at Q3 2013

State	Total Space (s.m)		Occupancy Rate (%)	
	Shopping Complex	Purpose-Built Office (Private Building)	Shopping Complex	Purpose-Built Office (Private Building)
Kuala Lumpur	2,409,996	7,114,689	83.5	77.8
W.P. Putrajaya	68,503	202,756	77.3	55.9
W.P. Labuan	26,063	49,120	98.3	73.6
Selangor	2,969,057	2,761,078	83.1	71.7
Johor	1,685,457	659,908	71.5	71.8
Pulau Pinang	1,479,114	842,196	68.9	75.8
Perak	723,294	236,241	87.7	88.6
Negeri Sembilan	382,551	124,790	82.9	85.3
Melaka	363,797	208,461	80.7	70.1
Kedah	425,242	153,787	78.3	88.7
Pahang	259,315	179,339	77.3	74.4
Terengganu	106,984	108,315	76.7	96.9
Kelantan	222,854	170,821	89.5	93.9
Perlis	69,605	40,501	94.8	100.0
Sabah	532,782	497,895	88.1	85.3
Sarawak	612,029	414,268	70.5	90.5
Malaysia	12,336,643	13,764,165	79.5	77.1



Catering 3D Environment Development

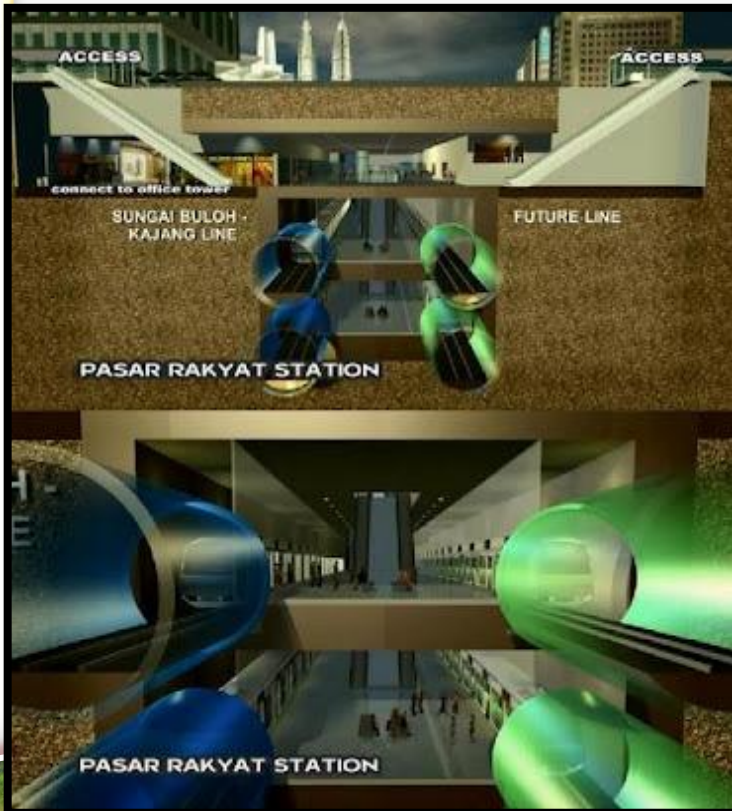

Malaysia's RM50bil Klang Valley public transport plan

- RM7bil Light rail transit extensions
- RM36bil Proposed mass rapid transit (MRT) system construction and design
- RM2bil Proposed MRT land acquisition
- RM3bil Proposed MRT rolling stock
- RM2bil Proposed MRT underground commercial space development

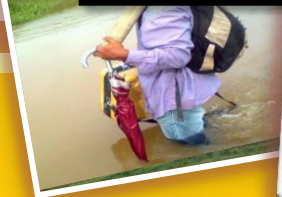



ADDRESSING THE RISING COST OF LIVING
Built to provide fast and cheap basic health services



IMPROVING URBAN PUBLIC TRANSPORT
Greater convenience and accessibility in the public transport system



21% A.M. peak public transport modal share



ASSURING QUALITY EDUCATION
Towards a brighter future for all

Expanded reach to Special Needs students

- 292 Special Needs students enrolled in vocational courses via the SEN Vocational Programme
- 11 schools involved with the Employment Transition Programme



FIGHTING CORRUPTION
Steady improvement in Transparency International's Corruption Perceptions Index (CPI)



IMPROVING RURAL DEVELOPMENT
Laying the ground for thriving rural economies

21ST CENTURY VILLAGE

Private-driven premium fruit and vegetable farms

2 Sites



Enhancing economic activities of village co-operatives under the Desa Lestari Programme

25 Kampung



Rural Business Challenge Winners

11 Winners



RAISING LIVING STANDARDS OF LOW-INCOME HOUSEHOLDS
Moved more Malaysians out of poverty

eKasih status 2013
462,571

Reasons for "Moved out from Poverty" status
188,781

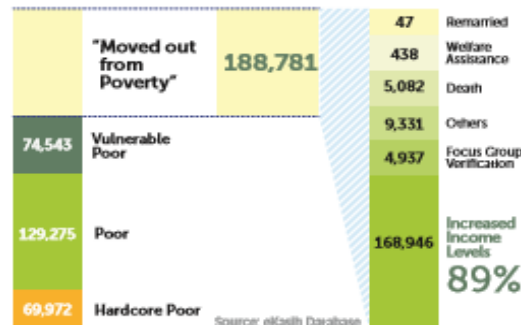

REDUCING CRIME
Clamped down on violent crime

OPS CANTAS KHAS AS OF 10TH DECEMBER 2013

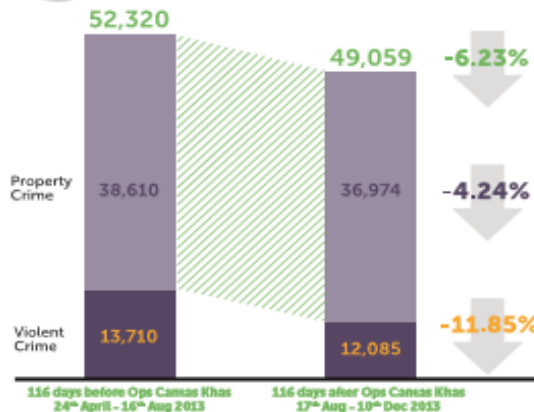

eKADASTER
supports NKRA
achievements

Proposing:

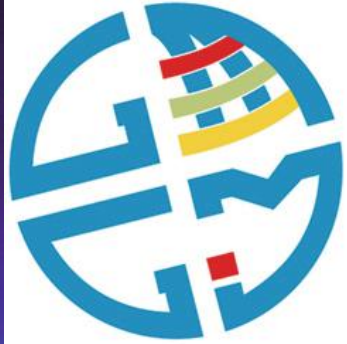

UN-GGIM-AP

REGIONAL COMMITTEE OF
UNITED NATIONS
GLOBAL GEOSPATIAL
INFORMATION MANAGEMENT
FOR ASIA & THE PACIFIC

**5th Plenary
Meeting,
October 2016,
Malaysia**





Thank You!



Department of Survey & Mapping
Malaysia

<http://www.jupem.gov.my>